



## ACCOMMODATION

Floor	Use	Sq ft	Sq m
First	Office	14,843	1,379.0
Ground	Office	18,697	1,737.0
	Winter Gardens	3,854	358.1
<b>Total</b>		<b>33,540</b>	<b>3,116.1</b>

- Reception
- Winter Garden

Plan not to scale,  
for indicative purposes only.



## Ground Floor - New Fit-Out

18,697 sq ft (1,737 sq m)

12 person meeting room	01	4 person meeting rooms	02	Informal meeting rooms	02
10 person meeting room	01	3 person meeting room	01	Breakout space/hotdesks	52
6 person meeting room	01	Phone booths	03	Winter Garden	01

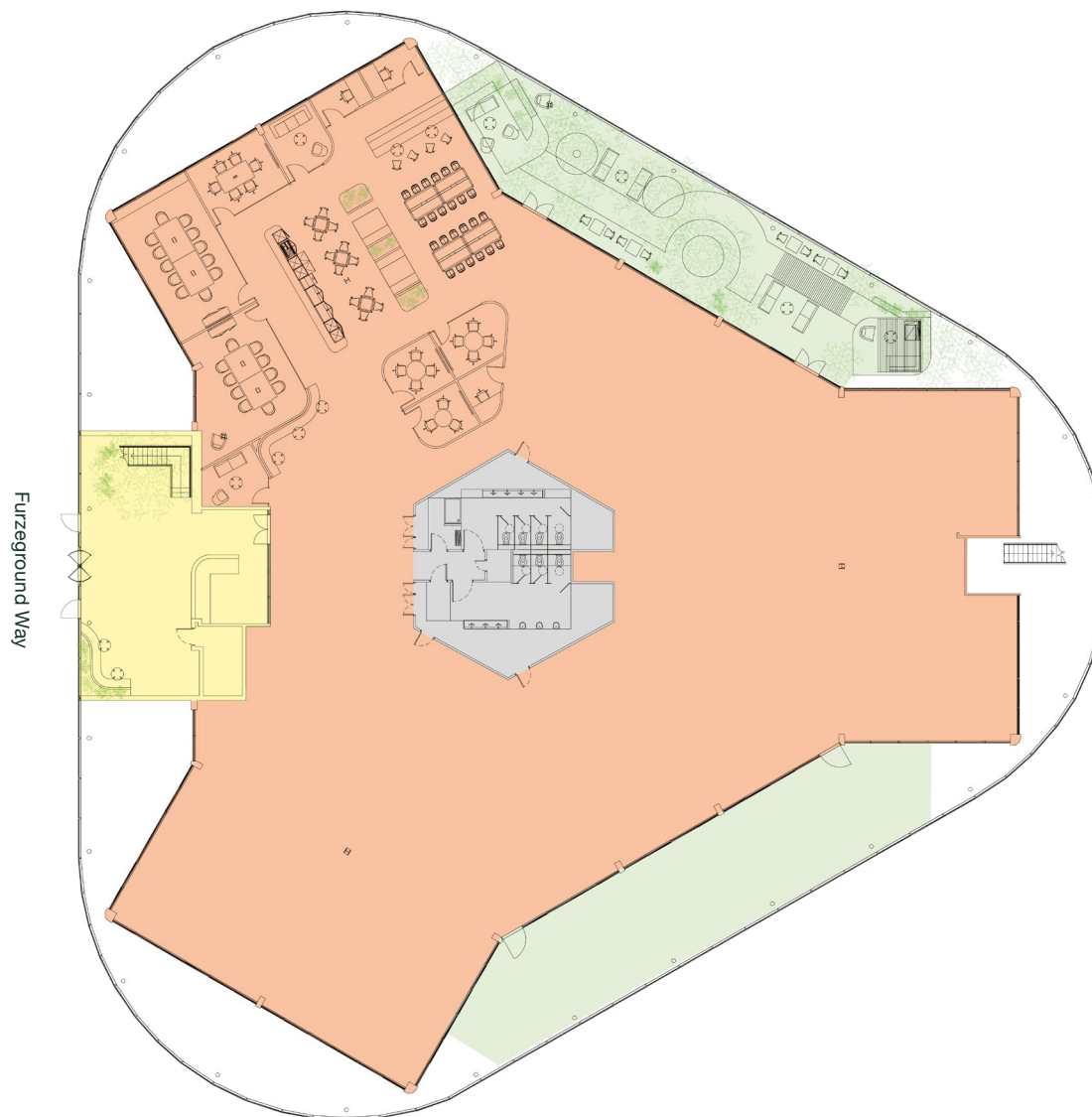



# ACCOMMODATION

Floor	Use	Sq ft	Sq m
First	Office	14,843	1,379.0
Ground	Office	18,697	1,737.0
	Winter Gardens	3,854	358.1
<b>Total</b>		<b>33,540</b>	<b>3,116.1</b>

- Reception
- Winter Garden

Plan not to scale,  
for indicative purposes only.



## Ground Floor Space Plan 18,697 sq ft (1,737 sq m)

Desks	112	5 person meeting rooms	02	Touchdown benches	04
Breakout space/hotdesks	56	4 person meeting rooms	02	6 person booths	05
12 person meeting room	01	3 person meeting room	01	Phone pods	08
10 person meeting room	01	Informal meeting rooms	02	Lockers	56
6 person meeting room	01	Phone booths	08	Winter Gardens	02

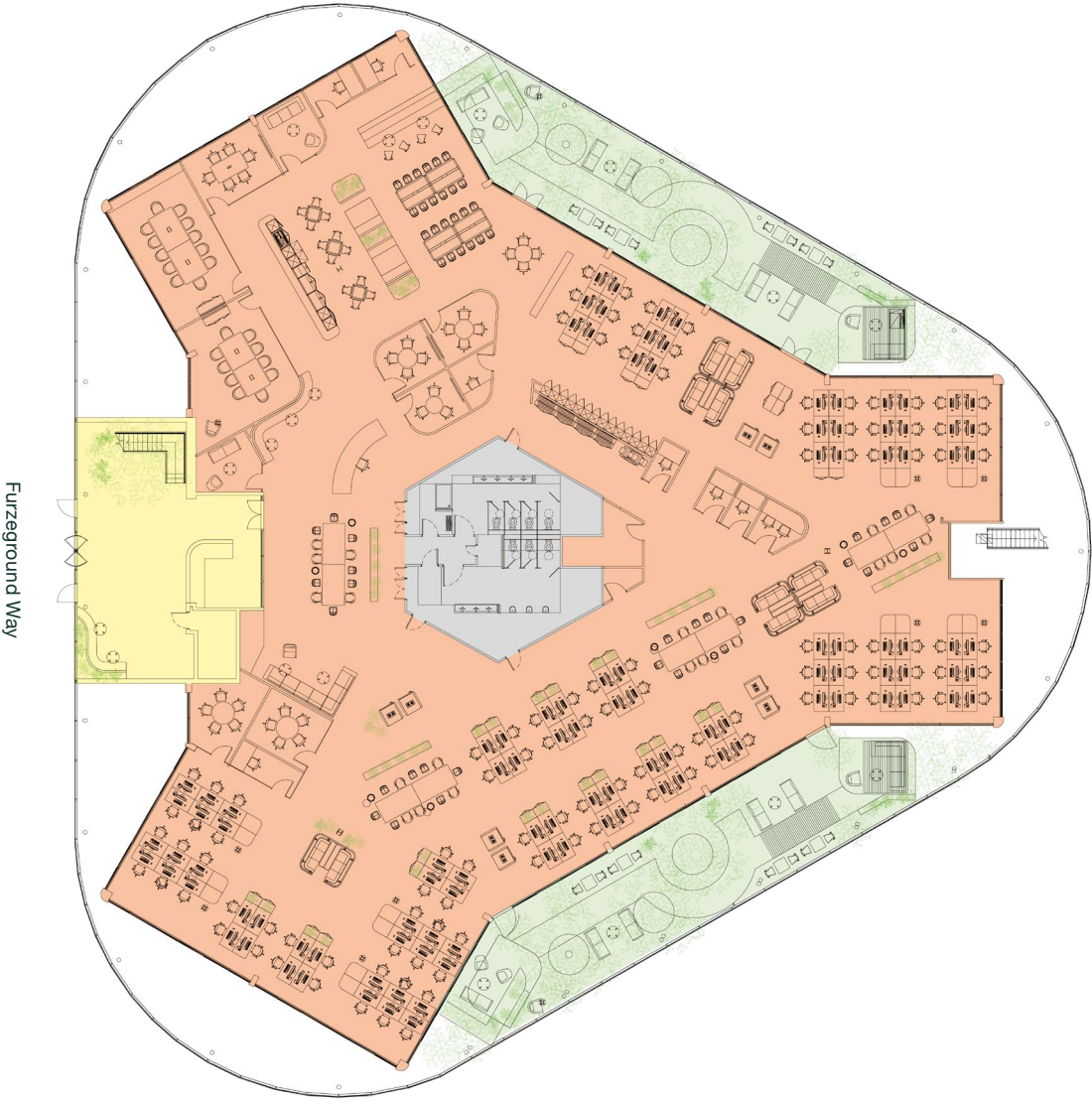



### ACCOMMODATION

Floor	Use	Sq ft	Sq m
First	Office	14,843	1,379.0
Ground	Office	18,697	1,737.0
	Winter Gardens	3,854	358.1
<b>Total</b>		<b>33,540</b>	<b>3,116.1</b>

- Reception
- Winter Garden  
(1,927 sq ft each)

Plan not to scale,  
for indicative purposes only.



### Indicative Ground Floor Split Plan

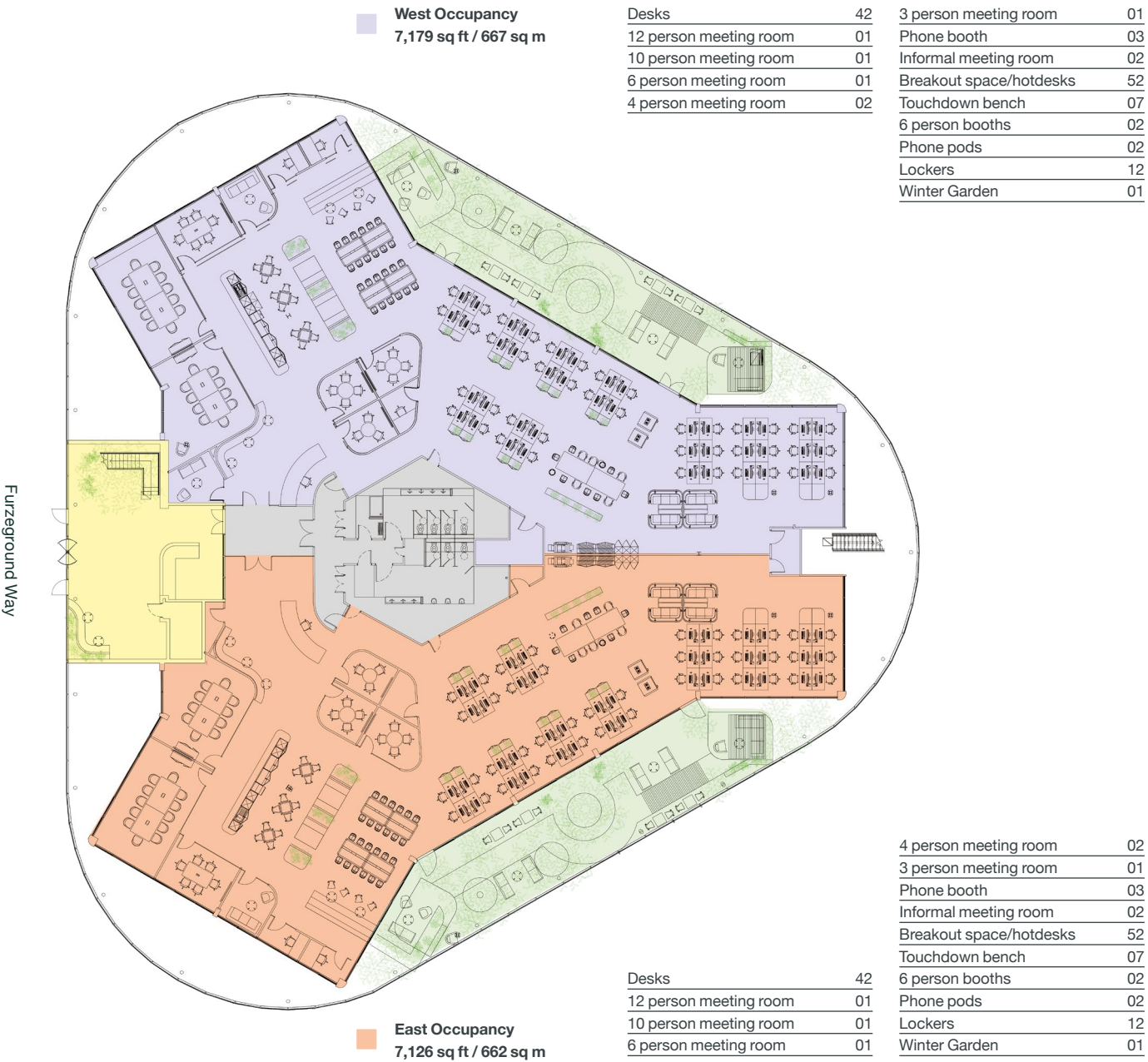



## ACCOMMODATION

Floor	Use	Sq ft	Sq m
First	Office	14,843	1,379.0
Ground	Office	18,697	1,737.0
	Winter Gardens	3,854	358.1
<b>Total</b>		<b>33,540</b>	<b>3,116.1</b>

Plan not to scale,  
for indicative purposes only.



## First Floor Plan

14,843 sq ft (1,379 sq m)

